

Delegated Decision

18 March 2024

Temporary Traffic Regulation Order

Ordinary Decision/Key Decision No.



Report of NEIGHBOURHOODS & CLIMATE CHANGE

Paul Anderson – Strategic Highways Manager, Technical Services

Electoral division(s) affected:

Wingate, Blackhalls Ward: Cllr J Higgins, Cllr R Crute, Cllr S Deinali

Purpose of the Report

To consider a request for temporary traffic regulation by Order on 29 April 2024 for the purpose of new telecom infrastructure installation works on Forest Gate, Woodland View, Taylor Grove, Whingrove Close, Ferndale Close, Wingate and Station Town.

Recommendation

It is recommended that the Council exercises its powers under the Road Traffic Regulation Act 1984 to effect a Temporary Traffic Regulation Order to facilitate the proposed works

Background

Works are proposed by Map Group on behalf of Virgin Media to undertake new telecom infrastructure installation works within the confines of the highway.

Options

Other traffic management arrangements have been considered and the most appropriate method is for temporary road and footpath closure for approx. 4 weeks.

Recommendation

The recommendation is approved and that following, consultations with the Chief of Police, arrangements be made to progress the advertising of Public Notices and sealing of an Order.

Contact: Steven Galloway

Tel: 03000 267095

Appendix 1: Implications

Legal Implications

TTRO checked, prepared and advertised via Legal Services

Finance

Costs to be charged to the scheme/applicant.

Consultation

Chief of Police, Local Members, Public Transport Providers (via the Public Transport Team)

Equality and Diversity / Public Sector Equality Duty

N/A

Human Rights

No impact

Crime and Disorder

N/A

Climate Change

N/A

Staffing

Network Management Team

Accommodation

N/A

Risk

N/A

Procurement

Advertising in a public newspaper with costs recharged to the scheme/applicant

TRAFFIC MANAGEMENT NOTES:
 1) All temporary traffic management shall be in accordance with Chapter 8 of the Traffic Signs Manual.
 2) All temporary traffic management shall be in accordance with the Traffic Signs Regulations and General Directions 2016.
 3) All temporary traffic management shall conform to the Safety at Street Works and Road Works, A Code of Practice.
 4) All signing should be located 450mm minimum from any carriageway.
 5) All temporary traffic management sign locations are indicative and are subject to on site approval from the Engineer.

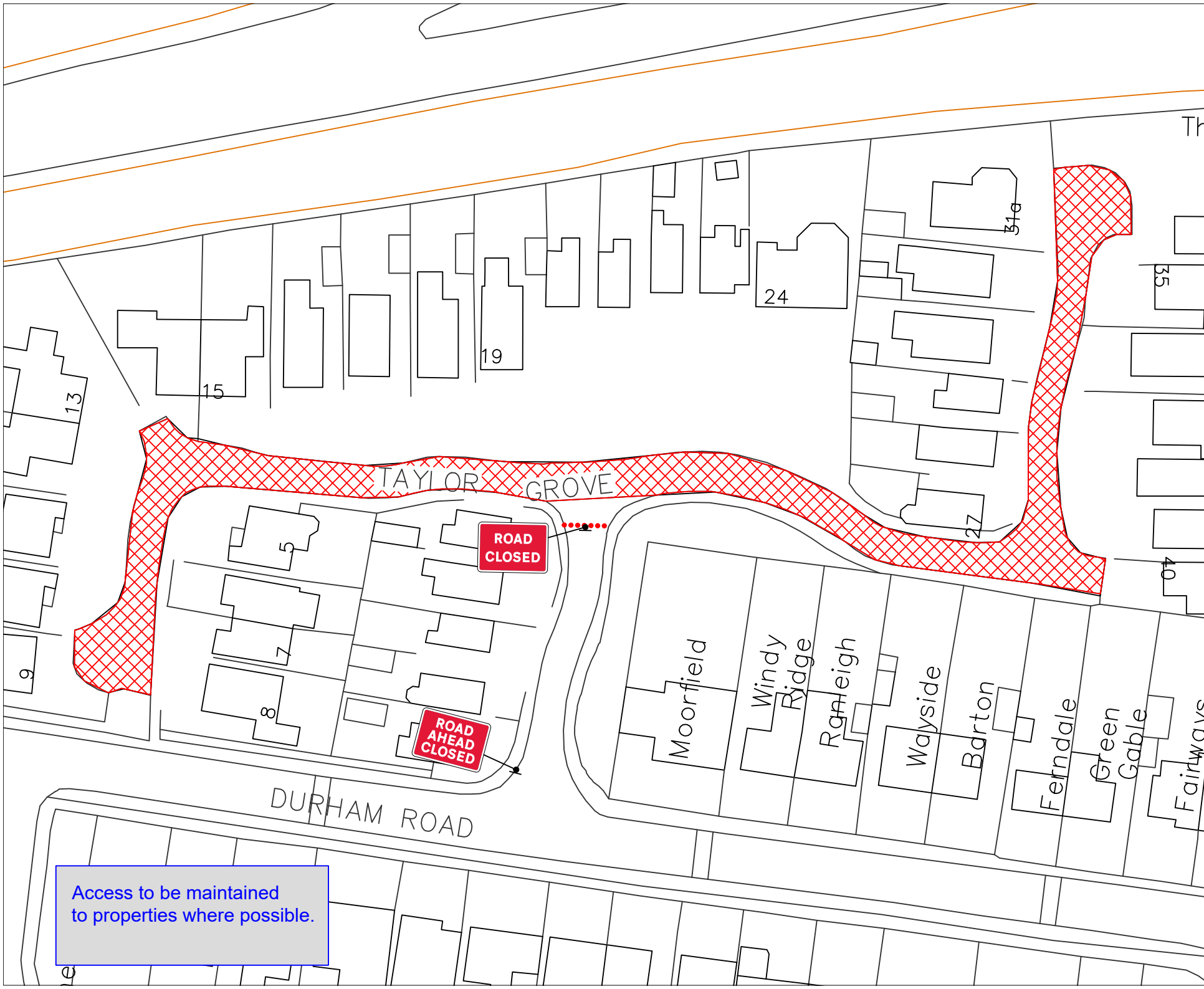

Key

- Traffic sign
- Traffic cone/cylinder
- No waiting cone
- Pedestrian barrier
- Road Closure
- Diversion route

N

QR Code:

Checked by: I.BOWDEN

Customer: MAP GROUP

Job reference: 11907393

Location: WINGROVE CLOSE
WINGATE
DURHAM

Date: 29/02/24

Description: Road Closure

Scale: NTS	OS HA: O
------------	----------

Core Highways
www.corehighways.com

Produced by: A.TAYLOR

Drawing reference: A1/29.02.24.DWG2542

Access to be maintained to properties where possible.



TRAFFIC MANAGEMENT NOTES:
 1) All temporary traffic management shall be in accordance with Chapter 8 of the Traffic Signs Manual.
 2) All temporary traffic management shall be in accordance with the Traffic Signs Regulations and General Directions 2016.
 3) All temporary traffic management shall conform to the Safety at Street Works and Road Works, A Code of Practice.
 4) All signing should be located 450mm minimum from any carriageway.
 5) All temporary traffic management sign locations are indicative and are subject to on site approval from the Engineer.

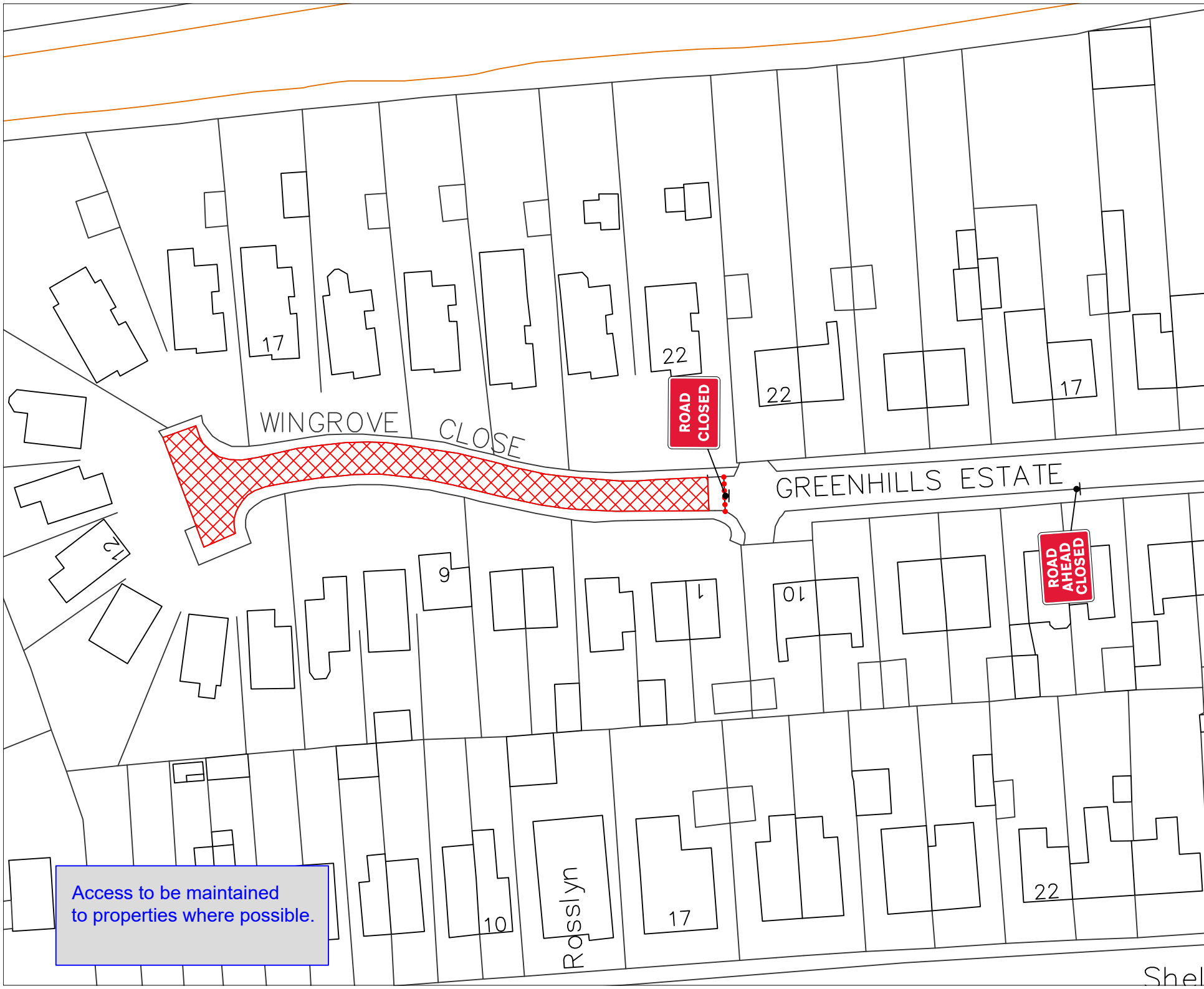

Key

- Traffic sign
- Traffic cone/cylinder
- No waiting cone
- Pedestrian barrier
- Road Closure
- Diversion route

QR Code:
 Checked by: I.BOWDEN
 Customer: MAP GROUP
 Job reference: 11907269
 Location: WINGROVE CLOSE
 WINGATE
 DURHAM
 Date: 29/02/24
 Description: Road Closure
 Scale: NTS OS HA: O
 Core Highways
 www.corehighways.com
 Produced by: A.TAYLOR
 Drawing reference: A1/29.02.24.DWG2541

Access to be maintained to properties where possible.



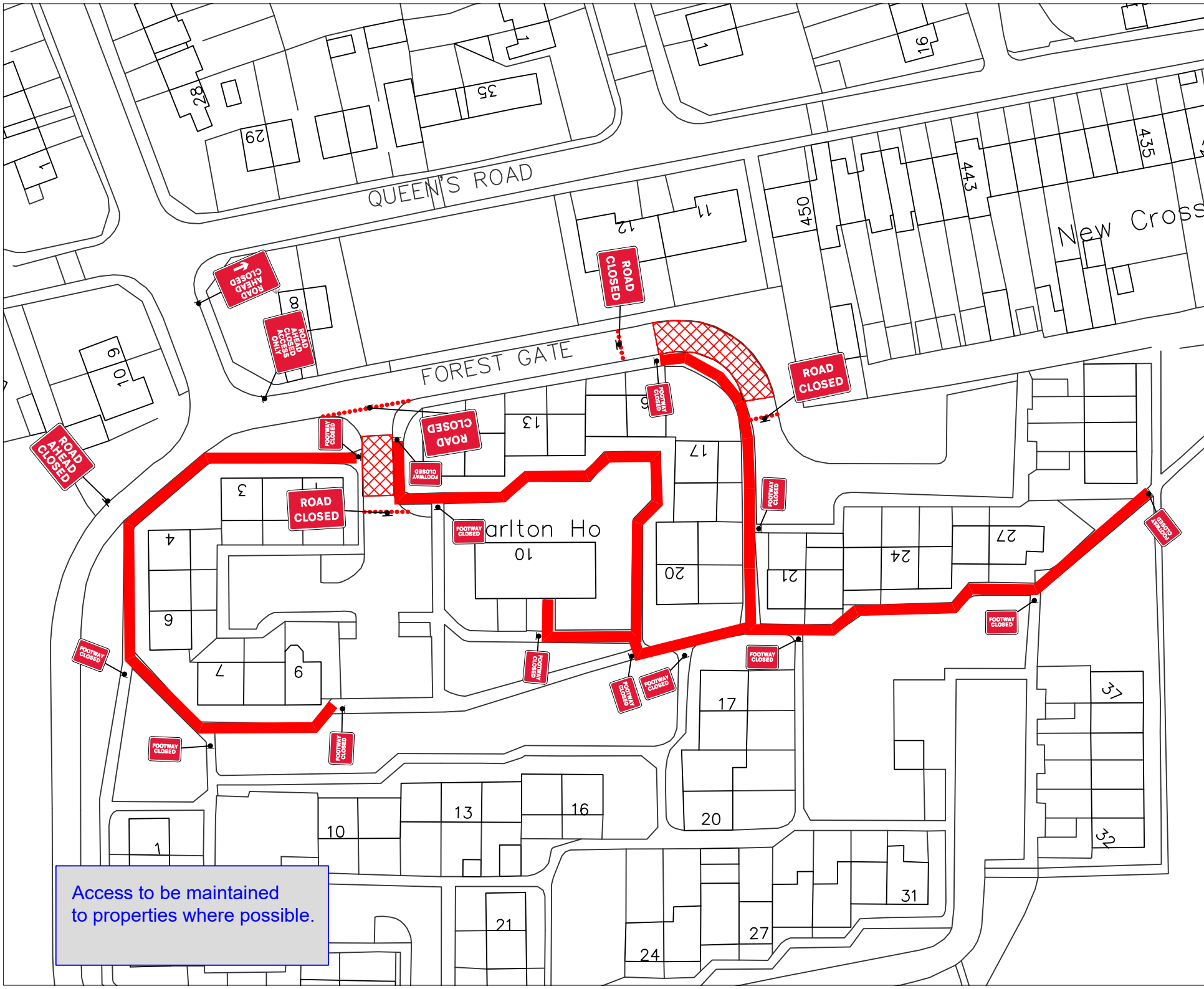

TRAFFIC MANAGEMENT NOTES:
 1) All temporary traffic management shall be in accordance with Chapter 8 of the Traffic Signs Manual.
 2) All temporary traffic management shall be in accordance with the Traffic Signs Regulations and General Directions 2016.
 3) All temporary traffic management shall conform to the Safety at Street Works and Road Works, A Code of Practice.
 4) All signing should be located 450mm minimum from any carriageway.
 5) All temporary traffic management sign locations are indicative and are subject to on site approval from the Engineer.

Key	
	Traffic sign
	Traffic cone/cylinder
	No waiting cone
	Pedestrian barrier
	Road Closure
	Diversion route

QR Code:	
Checked by: I.BOWDEN	
Customer: MAP GROUP	
Job reference: 11913960	
Location: FOREST GATE WINGATE DURHAM	
Date: 29/02/24	
Description: Road Closures / Footway Closures	
Scale: NTS	OS HA: O
Core Highways www.corehighways.com	
Produced by: A.TAYLOR	
Drawing reference: AT/29.02.24.DWG2539	

Access to be maintained to properties where possible.



TRAFFIC MANAGEMENT NOTES:
 1) All temporary traffic management shall be in accordance with Chapter 8 of the Traffic Signs Manual.
 2) All temporary traffic management shall be in accordance with the Traffic Signs Regulations and General Directions 2016.
 3) All temporary traffic management shall conform to the Safety at Street Works and Road Works, A Code of Practice.
 4) All signing should be located 450mm minimum from any carriageway.
 5) All temporary traffic management sign locations are indicative and are subject to on site approval from the Engineer.

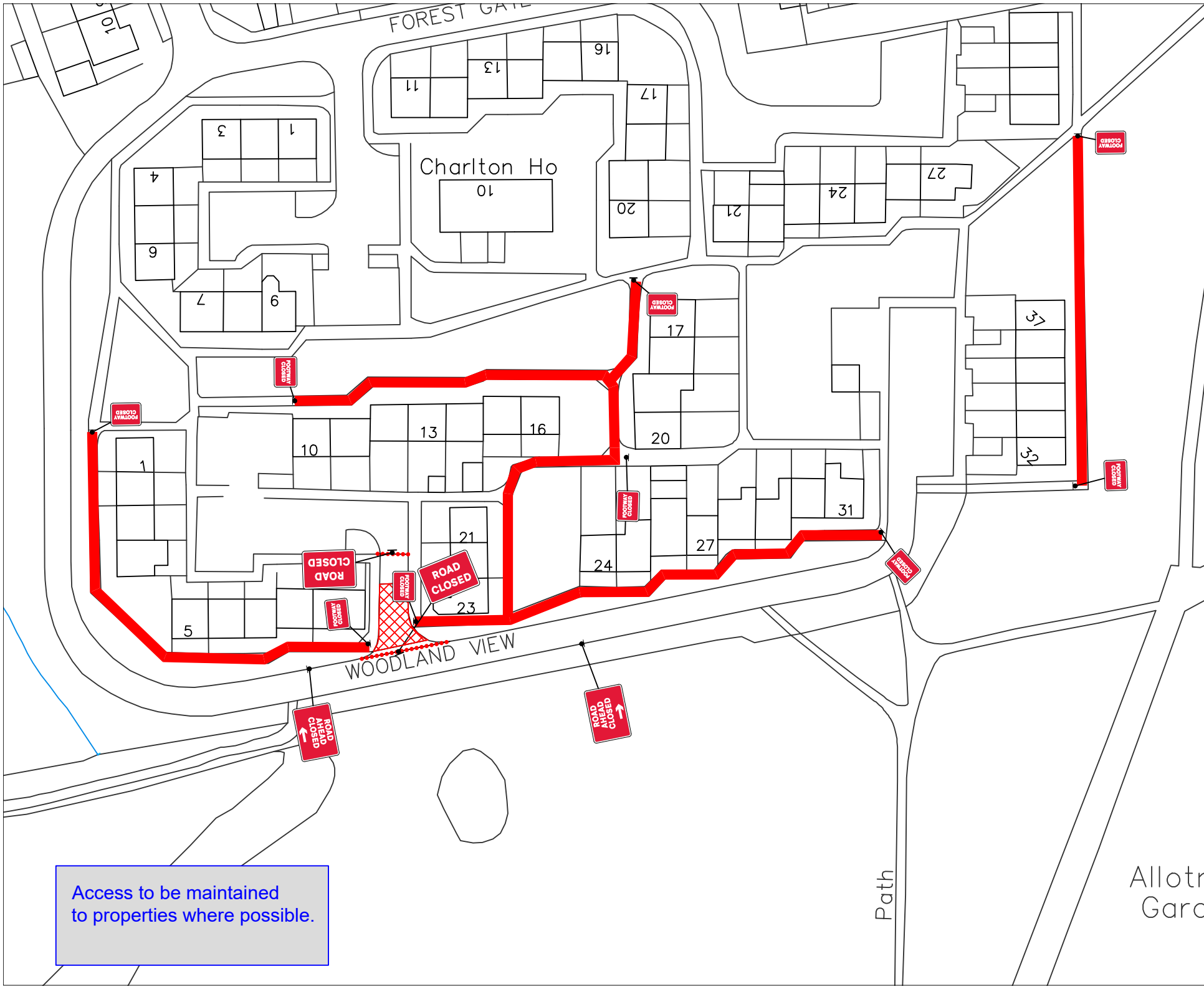

Key

- Traffic sign
- Traffic cone/cylinder
- No waiting cone
- Pedestrian barrier
- Road Closure
- Diversion route

N
↑
↓

QR Code:	
Checked by: I.BOWDEN	
Customer: MAP GROUP	
Job reference: 11907297	
Location: WOODLAND VIEW WINGATE DURHAM	
Date: 29/02/24	
Description: Road Closures / Footway Closures	
Scale: NTS	OS HA: O
Core Highways www.corehighways.com	
Produced by: A.TAYLOR	
Drawing reference: A1129.02.24.DWG2540	

Access to be maintained to properties where possible.

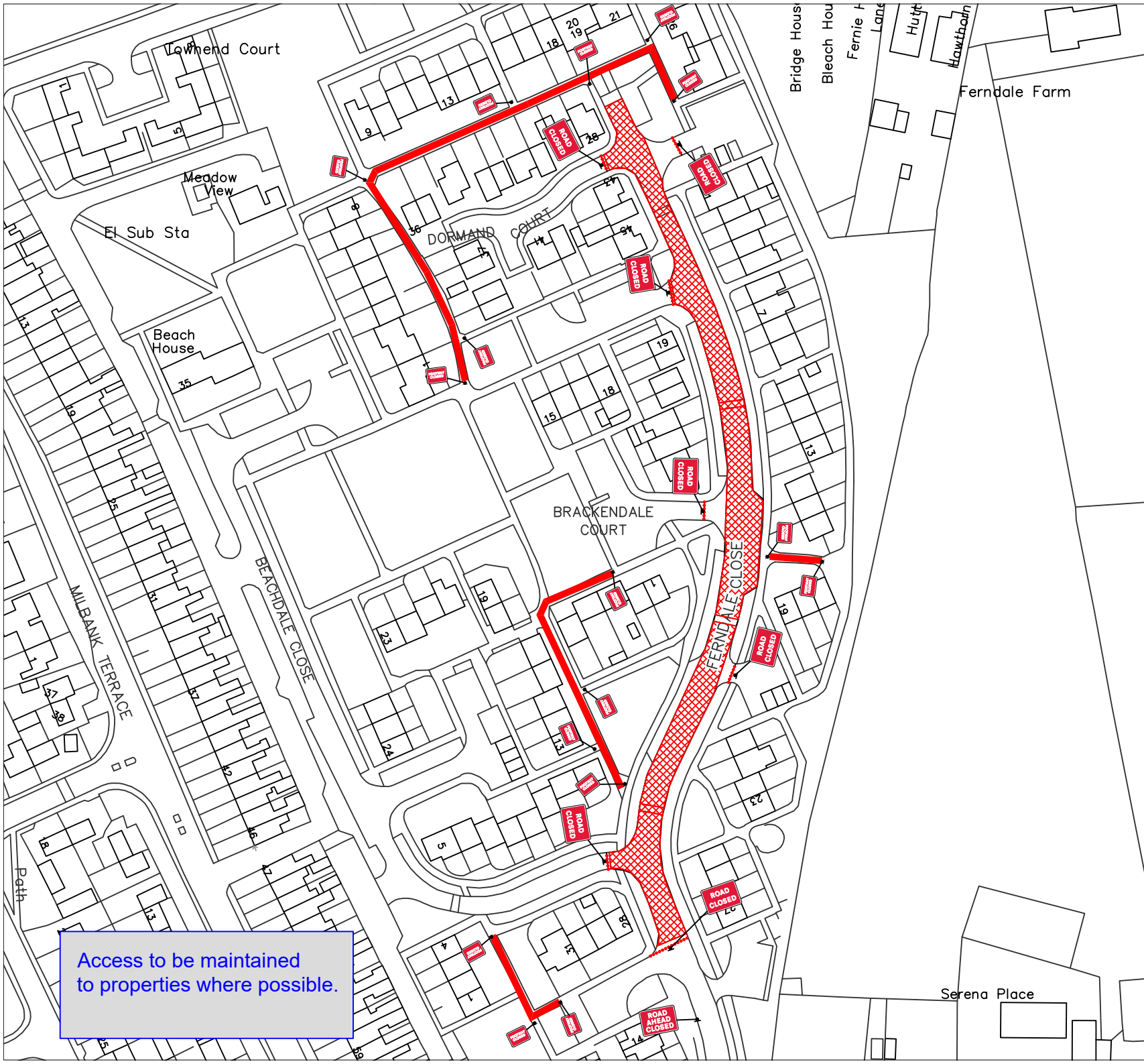

TRAFFIC MANAGEMENT NOTES:
 1) All temporary traffic management shall be in accordance with Chapter 8 of the Traffic Signs Manual.
 2) All temporary traffic management shall be in accordance with the Traffic Signs Regulations and General Directions 2016.
 3) All temporary traffic management shall conform to the Safety at Street Works and Road Works, A Code of Practice.
 4) All signing should be located 450mm minimum from any carriageway.
 5) All temporary traffic management sign locations are indicative and are subject to on site approval from the Engineer.

Key

- Traffic sign
- Traffic cone/cylinder
- No waiting cone
- Pedestrian barrier
- Road Closure
- Diversion route

N
↑
↓

QR Code:

Checked by: I.BOWDEN

Customer: MAP GROUP

Job reference: 1190730

Location: FERDALE CLOSE
STATION TOWN
WINGATE
DURHAM

Date: 29/02/24

Description: Road Closure / Footway Closures

Scale: NTS	OS HA: O
Core Highways www.corehighways.com	
Produced by: A.TAYLOR	
Drawing reference: A1/29/02/24.DWG2543	

Access to be maintained to properties where possible.

